

Sirocco

Smooth, safe and reliable showering

6100 2500 / 6100 2505

Sirocco Basic shower stretcher

The Sirocco Basic 6100 2500 combines a straightforward, height-adjustable design with user-friendly operation, making it an excellent choice for everyday care environments. With its electrically operated lifting system and intuitive hand control, caregivers can adjust the stretcher to the optimal working height, reducing physical strain and ensuring a more comfortable bathing experience for clients.

For facilities seeking a simplified solution, the Sirocco Basic 6100 2505 offers a fixed-height version that delivers the same robust build quality and client comfort. This model is particularly suitable where adjustability is less critical but reliability and ease of use remain essential. Both Sirocco Basic versions are equipped with the same high-quality materials and soft, supportive mattress, ensuring safety and comfort in daily care routines.

Foldable & Functional. Designed to save valuable floor space, the Sirocco folds away easily while maintaining full stability and performance.

Ergonomic Use. Height-adjustable design and smooth positioning reduce physical strain, ensuring comfortable and efficient care at any level.

Reliable & Long-Lasting. Built to last with a 60-month warranty for long-term reliability and peace of mind.

Antibacterial Coating & Corrosion-Resistant. The antibacterial coating with silver-ion supports hygiene and infection control, while the corrosion-resistant frame with smooth surfaces ensures durability and easy cleaning.

Discover our tools in action through the Interactive Product videos on our website: www.lopital.com

6100 2500

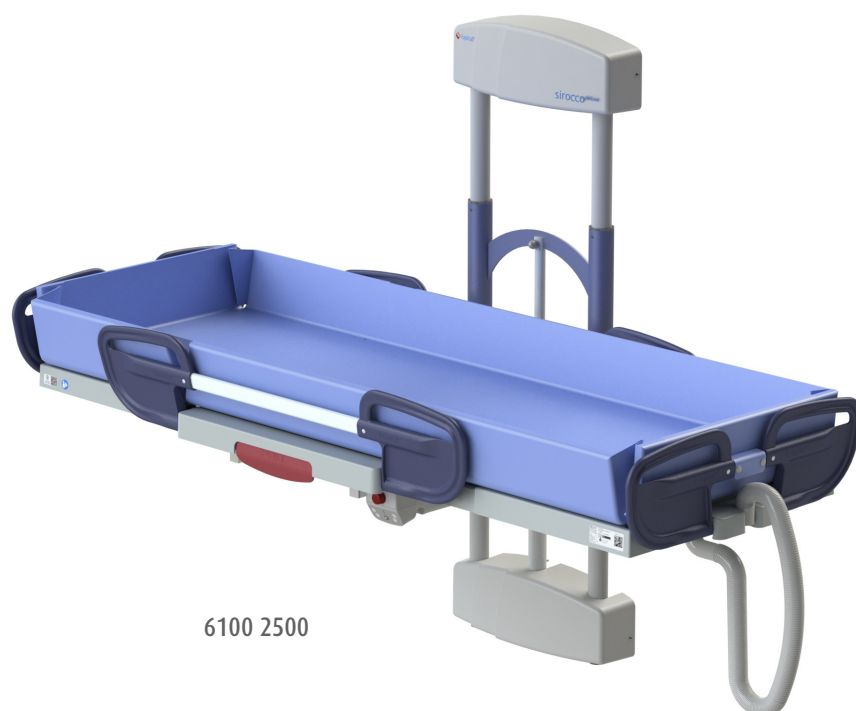

Technical Specifications

High / low drive	Electric (only 6100 2500)
Manual	Four-button hand control with hanging hook, IPX6
Control box	24VDC, max. 250 W, IPX6
Battery box	24V, 2.9 Ah, IPX6
Charger	100-240V AC, 50-60 Hz, max 1A, Wall charger

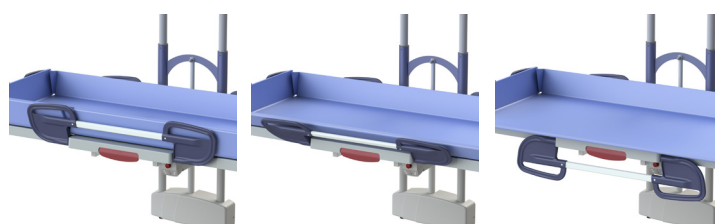

Suitable for people with severely reduced to very severely reduced mobility

6100 2505

Sirocco Basic fixed height shower stretcher

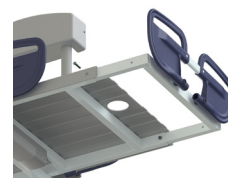

With built-in length adjustment.

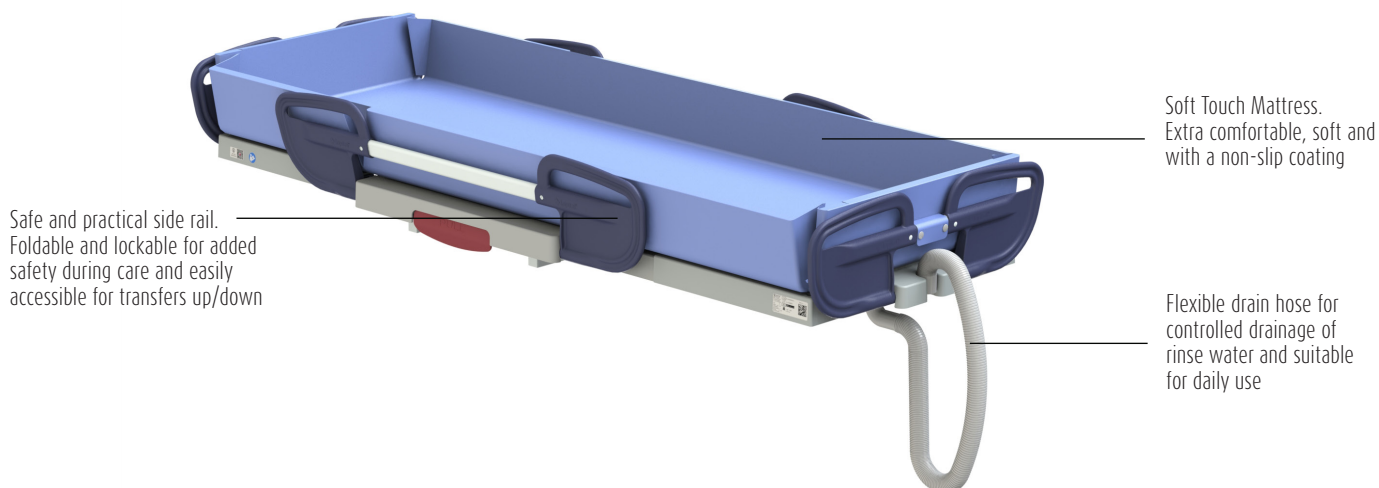

70205004
Hand control
with battery
indication



70205003
Battery box

Optional

70200034 Pillow
(a pillow is included with
the basic models).

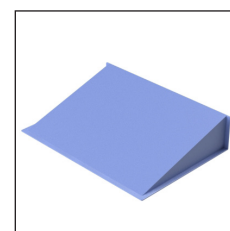

Art.no.	Art. description	Outer length	Outside width	Inner length	Inner width	High / low	Max. load	Product weight in kg
6100 2500	Sirocco Basic shower stretcher	186 206	93 / 36.6 inch	170-190 66.9 - 74.8 inch	70-93 27.6-36.6 inch	45-95 17.7-37.4 inch	227 kg / 500.4 lbs	75 kg / 165 lbs
6100 2505	Sirocco Basic shower stretcher	186 206	93 / 36.6 inch	170-190 66.9 - 74.8 inch	70-93 27.6-36.6 inch	-	150 kg / 330.7 lbs	71 kg / 156 lbs
6100 2510	Sirocco Deluxe shower stretcher	186 206	93 / 36.6 inch	170-190 66.9 - 74.8 inch	70-93 27.6-36.6 inch	45-95 17.7-37.4 inch	227 kg / 500.4 lbs	75 kg / 165 lbs
6720 0005	Mattress Basic 186 cm	-	-	170 / 66.9 inch	70 / 27.6 inch	-	-	-
6720 0010	Mattress Basic 206 cm	-	-	190 / 74.8 inch	70 / 27.6 inch	-	-	-
6720 0015	Mattress Deluxe 186 cm	-	-	170 / 66.9 inch	70 / 27.6 inch	-	-	-
6720 0020	Mattress Deluxe 206 cm	-	-	190 / 74.8 inch	70 / 27.6 inch	-	-	-

*All sizes in this table are in centimetres.

6100 2510

Sirocco Deluxe shower stretcher

The Sirocco Deluxe builds on the advantages of the Sirocco Basic models with added functionality for greater flexibility. Its stepless electric backrest adjustment allows clients to be positioned more comfortably, supporting both relaxation and care efficiency. This feature is particularly valuable in extended bathing or washing sessions, where varied positioning enhances comfort and reduces caregiver workload.

With its precise handling and smooth operation, the Sirocco Deluxe is designed for care environments where adaptability and client comfort are top priorities. It combines reliability with thoughtful features that help caregivers provide safe, dignified, and efficient hygiene care on a daily basis.



Folded position



Disassembly of lying plate and mattress

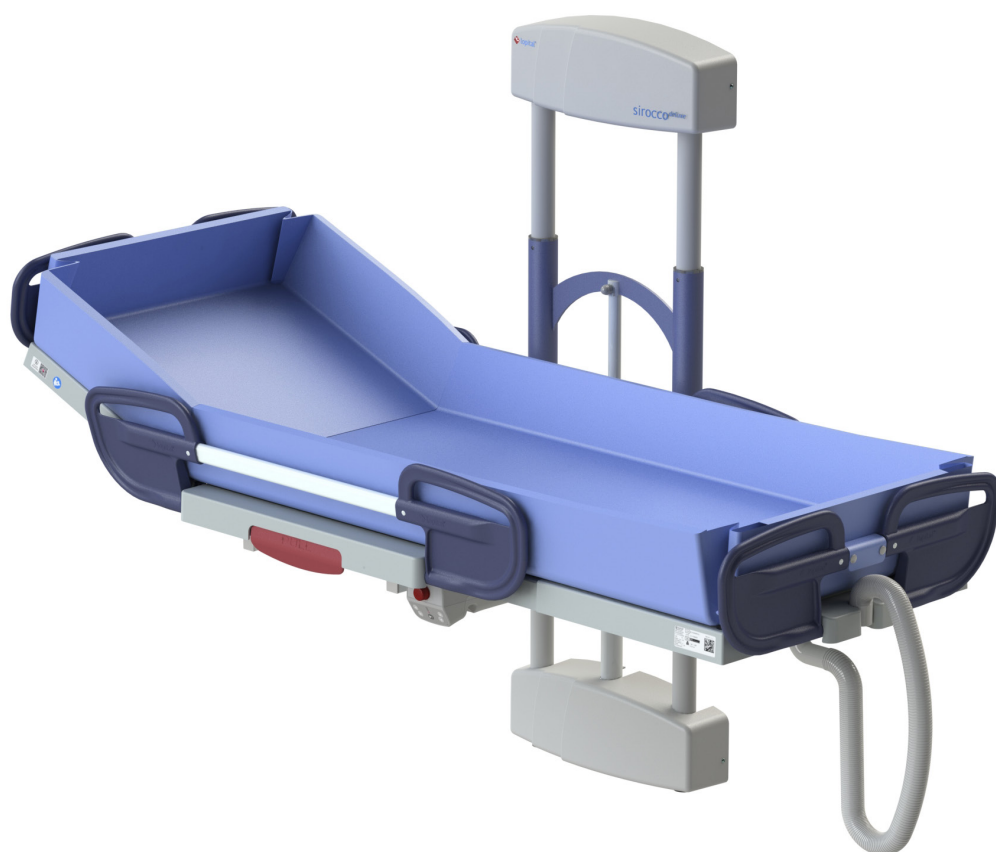

 Discover our tools in action through the Interactive Product videos on our website: www.lopital.com

Technical Specifications

High / low drive	Electric
Manual	Four-button hand control with hanging hook, IPX6
Control box	24VDC, max. 250 W, IPX6
Battery box	24V, 2.9 Ah, IPX6
Charger	100-240V AC, 50-60 Hz, max 1A, Wall charger
Back adjustment	up to 25 degrees



Suitable for people with severely reduced to very severely reduced mobility

Flame retardant (M2 standard).

Meets M2 fire safety standards for added protection in professional care environments.

Soft Touch mattress.

Extra comfortable, soft to the touch and equipped with a non-slip coating for added safety.

High scratch resistance

The durable surface resists wear and tear, maintaining a clean and professional appearance over time.

Antibacterial.

The mattress is antibacterial due to the addition of silver ions.

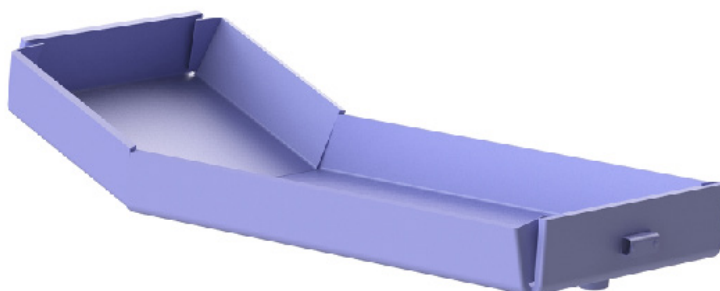
**REACH-compliant & cadmium-free.**

Produced in accordance with REACH standards and free from cadmium for safer, environmentally responsible use.

Safe & skin-friendly mattress.

Free from harmful substances like phthalates – ideal for sensitive skin and safe daily use.

Durable multi-layer mattress.

Composed of four layers of PVC for enhanced comfort, long-lasting support and excellent resistance to water and wear.

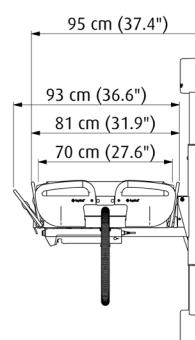
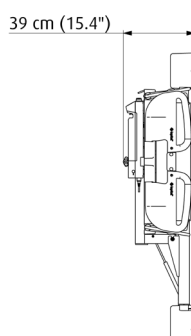
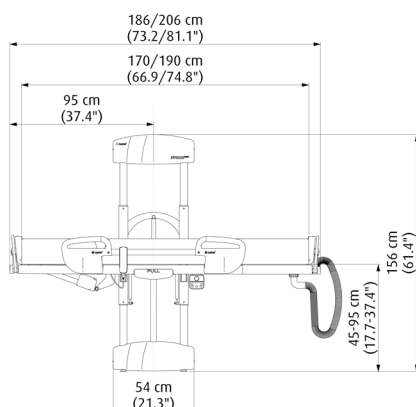
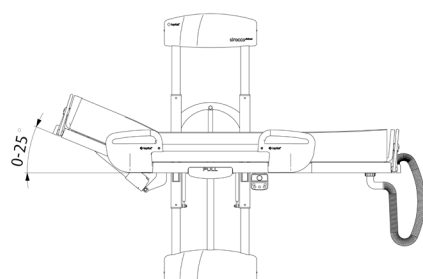
6100 2500**6100 2510****6100 2505**